

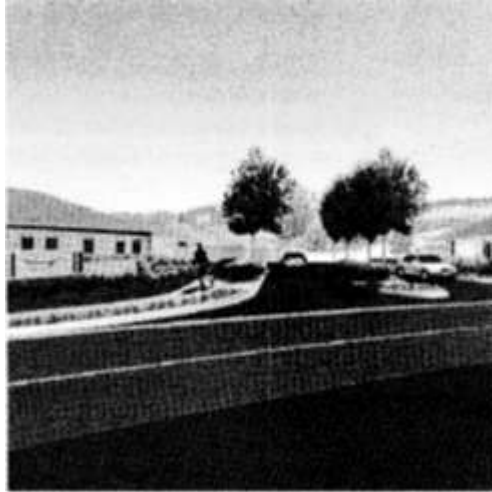

Adelaide Review
Friday 24/2/2006
Page: 38
Section: General News
Region: Adelaide Circulation: 29,020
Type: Magazines Lifestyle
Size: 104.88 sq.cms.
Published: Fortnightly

Brief: AVJ_MENT



Ten lots were snapped up on the first weekend release of the AVJennings master plan development, Pathways at Murray Bridge. More than 100 locals turned up to view the allotments on the banks of the Murray River, described by AVJennings as a style of development not seen in Murray Bridge for many years. Executive general manager Peter Jackson says housing demand is growing in Murray Bridge, "We're responding to a growing demand from locals, the community the council and from employers for quality land in new well-planned estate." Allotments range in price from the low \$70,000s to low \$100,000s. Jackson says SA is seeing significant growth spurts in regional towns. "As land has become much more expensive in the metropolitan area, people are jumping the boundaries for land and housing," he says.

Pathways is a 238-allotment development starting at 412 square metres. Over a third of the development is dedicated to parks and reserves along with walking trails, boardwalks, and integrated wetlands. There also is a state-of-the-art stormwater filtration, which will see stormwater pass through wetlands that clean the water to a high quality before it is discharged into the River Murray.